

NEW PRODUCTS



800~221~5644
www.imcteddy.com

Round Can Washer

NEW



RCW
List - \$3,050.

RCW-D
List - \$4,510.

The Round Can Washer is designed to sanitize, wash and rinse all size and shape cans, drums and barrels up to 25" opening. Hot water inlet is suitable for 180 degree hot water washing and sanitizing, to meet *US FDA food code 2009, 4-6 for Sanitizing and Cleaning of Utensils and Equipment*. Cold Water Inlet provides pot washing/rinsing capability and the spray hose unit is used to pre-rinse equipment and remove debris at the bottom of the Can Washer.

The RCW- D includes a Waste Disposer with a separate on/off switch. This allows the crushing and disposing of solid particle waste from the cleaning cycle, helping keep drain lines clear and speeding cleaning cycles. Timer controlled hot and cold water inlets are provided with the RCW- D. Timers may be easily adjusted.

The Mop Sink and Combination Clean & Soiled Utility Cabinets are designed for use where space is limited and helps follow acceptable sanitary practices in any size facility. Mop buckets for kitchen and customer areas can be easily emptied, cleaned and refilled as needed. Cross bars provided are used to convert the unit to cleaning cans and individual pots.

The shelf provides storage space for cleaning supplies. Optional removable sink covers provide additional storage when the sinks are not being used.

The design features an attractive finish of the IMC/Teddy Cabinets allows placing these units in cooking, prepping and customer areas. Compact facilities are particularly suited for use of this unit, as are most other establishments.



Mop Sink Cabinet

MSC
List - \$4,440.

Utility Cabinet

CMSC
List - \$6,040.

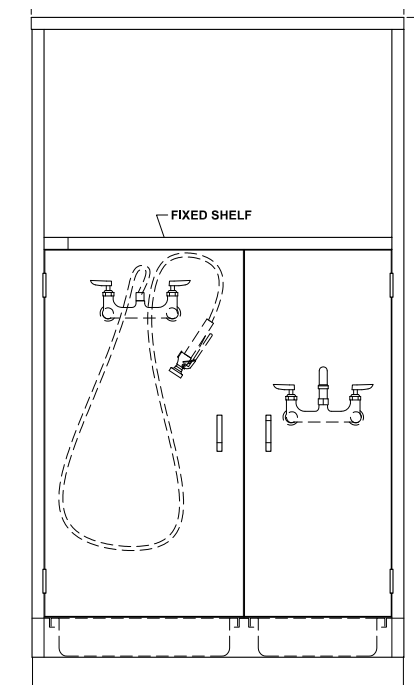
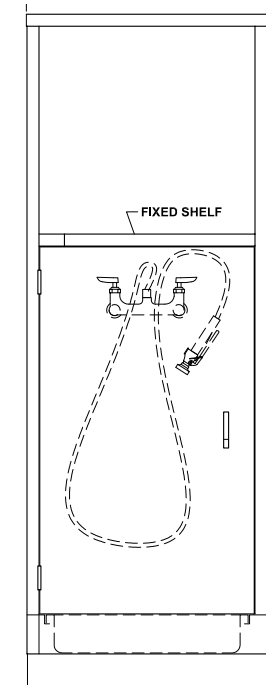



Hand Sinks



Cabinets



Bayonne Products

Floor Troughs & Grating



Modular Serving Systems

