



# Specifications

F.O.B Sedalia, Missouri 65301



### OPTIONS:

- Remote installation of unit
- Stainless steel louvered grille
- Glass display shelves - **98x Series**
- Buffet shelves - **83x, 93xFL, 93xHT, 93xBL**
- Serving shelves - **956/956-460 - x Series**
- Designer Food Shield - **TS530-xx, TS530-xx-1SN**

### AGENCY LISTING:



**DUKE MANUFACTURING CO.**  
 2305 N. Broadway  
 St. Louis, MO 63102

**800.735.3853 Toll Free**  
**314.231.5074 Fax**  
**www.dukemfg.com**

### Approval Stamp(s):

### PRODUCT INFORMATION:

PROJECT: \_\_\_\_\_  
 ITEM: \_\_\_\_\_  
 QUANTITY: \_\_\_\_\_

### MODEL:

### Drop-Ins - Cold Pan Tri Channel - NSF Standard 7

- ADI-1M-TC**                    18-1/8" length unit
- ADI-2M-TC**                    30-7/8" length unit
- ADI-3M-TC**                    43-5/8" length unit
- ADI-4M-TC**                    56-3/8" length unit
- ADI-5M-TC**                    69-1/8" length unit
- ADI-6M-TC**                    81-7/8" length unit

### TOP RIM:

- Heavy gauge, 300 Series stainless steel
- Overhand on front, back and ends
- Reinforced rim
- Vinyl foam gasket as sealant
- 300 Series stainless steel liner
- Insulated all sides and bottom

### REFRIGERATION:

- Copper coils attached to sides of liner - R404A refrigerant
- Open angle-iron suspended compressor compartment
- Remote mounted on/off switch with stainless steel face plate
- 120 volt unit
- 6' cord and plug
- Five year warranty on compressor motor

### EXTERIOR HOUSING

- Heavy gauge paint grip steel

### SHORT FORM SPECIFICATIONS:

#### **Aerohot™ Drop-In - Cold Pan - Tri-Channel - NSF Standard 7.**

Top rim shall be constructed of heavy gauge 300 Series stainless steel. Unit provided with a 3 rail Tri-Channel NSF Standard 7 pan designed to hold 1/3rd, 1/6th and 1/9th size pans without the use of adaptor bars. Standards include: pull out compressor slides, on/off switch, 6' electric cord and plug and 5 year compressor motor warranty.

**ADI-TC**

DROP-IN - COLD PAN - TRI-CHANNEL - NSF STANDARD 7

Catalog No. ADI-TRIN7

A.I.A. File No. 35-C-13



MODEL:

**Drop-Ins**  
**Cold Pan - Tri Channel**  
**MEETS NSF Standard 7**

- ADI-1M-TC 18-1/8" length unit
- ADI-2M-TC 30-7/8" length unit
- ADI-3M-TC 43-5/8" length unit
- ADI-4M-TC 56-3/8" length unit
- ADI-5M-TC 69-1/8" length unit
- ADI-6M-TC 81-7/8" length unit

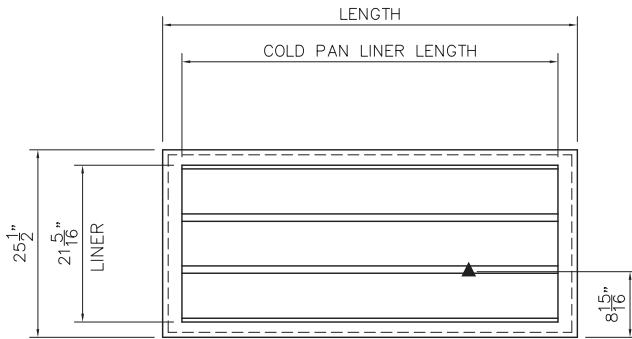

ADI-4M-TC UNIT SHOWN

TOP VIEW

LEGEND	
▲	- ELECTRICAL CONNECTION

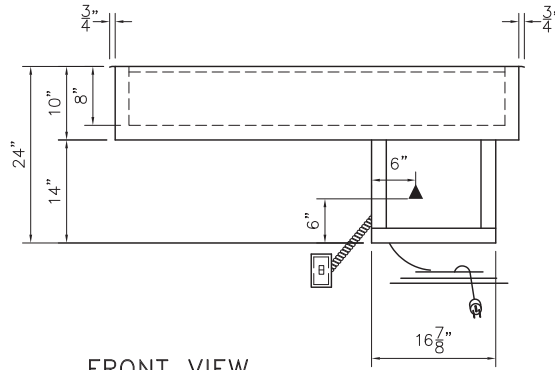

FRONT VIEW

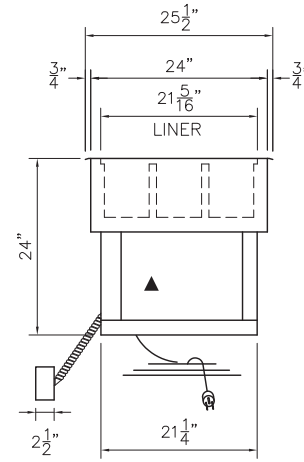

RIGHT SIDE VIEW

FREIGHT CLASS: 100

Model	Overall Length	Overall Length	Tri-Channel Top Cutout Dimensions		Cubic Ft. Crated	Weight		120.1 NEMA #5-15P	
			Length	Width		lbs.	kg	amps	hp
ADI-1M-TC	18-1/8	25-1/2	17-1/8	24-1/2	14.0	180	82	5.5	1/4
ADI-2M-TC	30-7/8	25-1/2	29-7/8	24-1/2	22.1	190	86	5.5	1/4
ADI-3M-TC	43-5/8	25-1/2	42-5/8	24-1/2	24.5	205	93	6.7	1/3
ADI-4M-TC	56-3/8	25-1/2	55-3/8	24-1/2	38.4	310	141	6.7	1/3
ADI-5M-TC	69-1/8"	25-1/2	65-1/8	24-1/2	46.5	370	168	6.5	0.4
ADI-6M-TC	81-7/8	25-1/2	80-7/8	24-1/2	54.6	410	186	6.5	0.4



**DUKE MANUFACTURING CO.**  
 2305 N. Broadway  
 St. Louis, MO 63102

800.735.3853 Toll Free  
 800.231.1130 In Missouri  
 314.231.5074 Fax  
[www.dukemfg.com](http://www.dukemfg.com)

Specification subject to change

01/10  
 Printed in U.S.A  
 © 2010, Duke Manufacturing Co.