

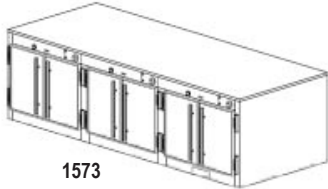

# Specifications

F.O.B Sedalia, Missouri 65301



1573

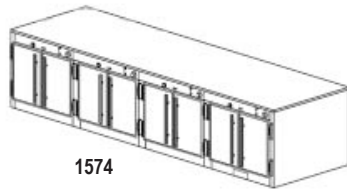

1574

### OPTIONS:

- Enclosed base - 6" high
- Cord and plug - 8'
- Casters - 5" polyurethane, 2 swivel w/brakes 2 rigid
- Push bar
- Bumpers - stainless steel
- Door Panels - laminated plastic
- Additional pair 5" angle slides
- Door locks
- Legs
- 440-480V Circuit
- Celsius thermometer in lieu of Fahrenheit
- 208V/1Ph; 208V/3Ph; 240V/1 PH; 240/3PH

### AGENCY LISTING:



**DUKE MANUFACTURING CO.**  
 2305 N. Broadway  
 St. Louis, MO 63102

**800.735.3853 Toll Free**  
**314.231.5074 Fax**  
**www.dukemfg.com**

## Approval Stamp(s):

### PRODUCT INFORMATION:

PROJECT: \_\_\_\_\_  
 ITEM: \_\_\_\_\_  
 QUANTITY: \_\_\_\_\_

### MODEL:

## Thermotainer Food Holding Cabinets - "D" Series 16-3/4"H x 22"W x 28-1/2" D Compartments

- 1573** Reach-In 1 thermostat per compartment , w/o legs
- 1573P** Pass-Thru 1 thermostat per compartment, w/o legs
- 1574** Reach-In 1 thermostat per compartments , w/o legs
- 1574P** Pass-Thru 1 thermostat per compartments, w/o legs

### BODY:

- Heavy gauge stainless steel, all panels except bottom
- Shell welded to interior
- Die-stamped compartment openings

### DOORS:

- Stainless steel Uni-Door construction
- Operate simultaneously, either opening or closing
- Overhead operating unit
- Automatic stop holds open position
- Spring hinges die-stamped, with built-in-stop externally adjustable, completely concealed

### COMPARTMENT:

- Heavy gauge stainless steel
- Rounded corners
- Stainless steel studs for angle slides at 3 levels
- (3) removable, adjustable, stainless steel, 5" angled slide pairs
- Removable liner for inspection and maintenance

### ELECTRICAL CONTROLS:

- Recessed thermostat w/built-in On-Off switch
- Heat range 100° - 300° and dial thermometer
- Pilot lights
- Recessed connection box
- Thermostat, pilot lights set in removable access panel

### DAMPERS:

- 2-position sliding type
- Controlled by push buttons
- Compartments individually controlled

### INSULATION:

- Body fully insulated with 1-1/2" fiberglass, doors with fiberglass.

### HEATING ELEMENTS:

- Sheath type strip heaters, 120 Volt, 1 Phase
- Removable compartment for ease of access to heating elements.

### SHORT FORM SPECIFICATIONS:

**Duke Thermotainers Food Holding Cabinets.** Models 1573/1573P constructed with three (3) compartments. Models 1574/1574P to have four (4) compartments. Compartments 16-3/4"H x 22"W x 28-1/2"D. Each compartment to have three (3) pairs of removable stainless steel slides. One thermostat per compartment. 100o - 300oF heat range with dial thermometer. Built-in installation - allow 1/4" tolerance greater than body width.



**THERMOTAINER FOOD HOLDING CABINETS - "D" SERIES  
16-3/4"H x 22"W x 28-1/2"D COMPARTMENTS**

- 1573 Reach-In 1 thermostat per compartments, w/o legs
- 1573P Pass-Thru 1 thermostat per compartments, w/o legs
- 1574 Reach-In 1 thermostat per compartments, w/o legs
- 1574P Pass-Thru 1 thermostat per compartments, w/o legs

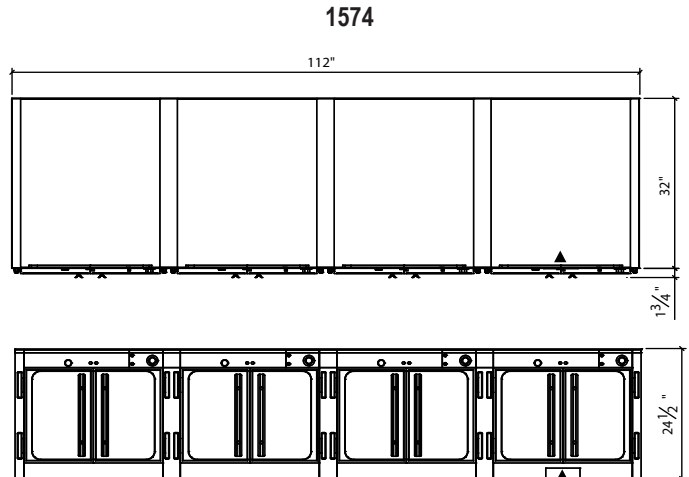
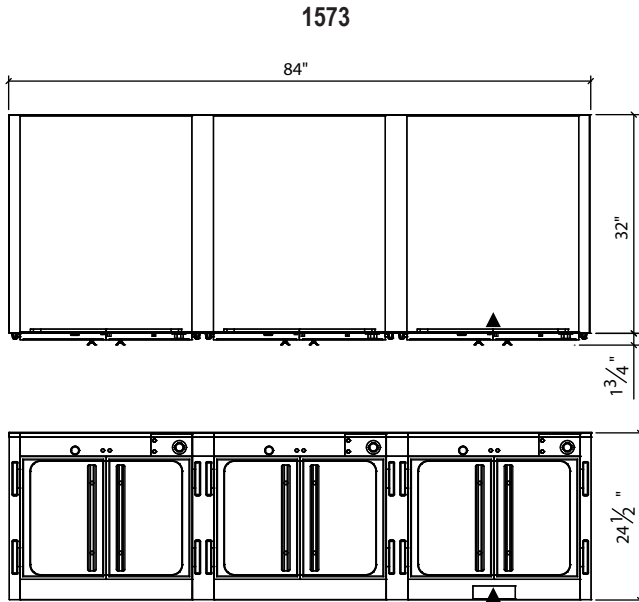

**DIMENSIONS:**

FREIGHT CLASS: 100

Model	Width		Depth		Height		Comp. Depth		Cube ft. crated	Weight	
	in.	cm.	in.	cm.	in.	cm.	in.	cm.		lbs.	kg
1573	84	213.4	33-3/4	85.7	24-1/2	62.2	28-1/2	72.4	63.9	750	340.9
1573P	84	213.4	35-1/2	90.2	24-1/2	62.2	30-1/2	77.5	66.9	750	340.9
1574	112	284.5	33-3/4	85.7	24-1/2	62.2	28-1/2	72.4	83.8	950	431.8
1574P	112	284.5	35-1/2	90.2	24-1/2	62.2	30-1/2	77.5	87.7	950	431.8

**ELECTRICAL SPECIFICATIONS:** (Consult factory for 3-phase electrical requirements and other options.) 120V, 1Ph

Model	Connected Load
1573	3000 watts
1573P	3000 watts
1574	4000 watts
1574P	4000 watts

	1573/1573P	1574/1574P
<b>Capacity w/standard slides</b>	(30) 12" x 20" x 2" pans or (18) 12" x 20" x 4" pans or (12) 12" x 20" x 8" pans (15) 18" x 26" bake sheets	(40) 12" x 20" x 2" pans or (24) 12" x 20" x 4" pans or (16) 12" x 20" x 8" pans (20) 18" x 26" bake sheets

- 1573 Reach In - hinged doors on front only
- 1573P Pass Thru - hinged doors on front & back for pass-thru service
- 1574 Reach In - hinged doors on front only
- 1574P Pass Thru - hinged doors on front & back for pass-thru service



**DUKE MANUFACTURING CO.**  
 2305 N. Broadway  
 St. Louis, MO 63102  
 800.735.3853 Toll Free  
 800.231.1130 In Missouri  
 314.231.5074 Fax  
 www.dukemfg.com

Specification subject to change