

APPLICATION:

JOB NAME:

QUANTITY: ITEM NO.

PRODUCT NAME: STAINLESS STEEL
8" ADJ. WALL MOUNT HOSE STYLE
POT FILLER

SPECIAL CONFIGURATION
 24171 CHECK BASE MODEL AND OPTIONS

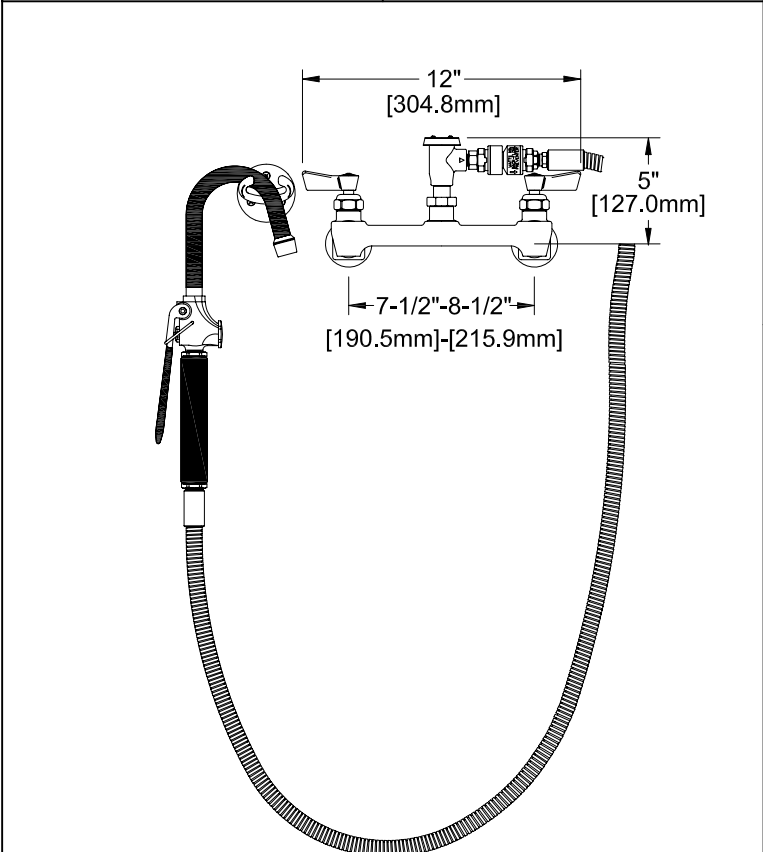

- OPTIONS OR MODIFICATIONS:
- SUPPLY LINES (24" OR 36") CIRCLE LENGTH
 - ADD-ON FAUCET (6",8",10",12",14",16") CIRCLE LGTH
 - IN-LINE DUAL CHECK VALVE
 - PIPE HOOK
 - NIPPLES
 - ELBOWS
 - VANDAL RESISTANT KIT
 - HANDLES (CROSS OR WRIST) CIRCLE STYLE
 - OTHER 48" HOSE FG

- FEATURES:
- CONTROL VALVE**
- * ECCENTRICS ADJUST FROM 7-1/2" TO 8-1/2"
 - * INTERNAL SPRING LOADED CHECK VALVES
 - * SWIVELLING SEAT DISKS
 - * HOT SIDE STEM - RIGHT HAND
 - * COLD SIDE STEM - LEFT HAND
 - * STAINLESS STEEL SEATS
 - * STAINLESS STEEL SEAT SCREWS
 - * STAINLESS STEEL HANDLE SCREWS
- HOSE**
- * 48" LENGTH
 - * STAINLESS STEEL END FITTINGS
 - * STAINLESS STEEL EXTERNAL JACKET
 - * BRAIDED USDA APPROVED FOODGRADE INTERNAL HOSE
 - * REPAIRABLE IN FIELD WITH SIMPLE TOOLS
- POT FILLER VALVE**
- * NON-SCRATCHING/ MARRING TUBE
 - * 5.0 GPM AT 80 PSI
 - * AERATED STREAM
- SWIVEL VACUUM BREAKER**
- * 360° TURNING RADIUS
 - * ATMOSPHERIC VACUUM BREAKER
- SYSTEM LIMITS**
- * TEMP: 40°F MIN. TO 140°F MAX.
 - * PRESSURE 200 PSI MAX. STATIC
- SHIPPING WEIGHT**
- * 11.5 LBS
- NSF 61-9 APPROVED & LISTED
* www.truesdail.com

ROUGH-IN:

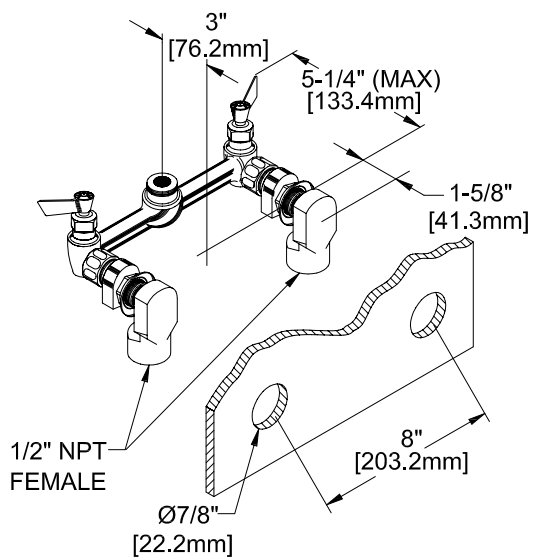

ANSI/A112.18.1M

FISHER
FISHER MANUFACTURING COMPANY
TOLL FREE: 800-421-6162 - FAX: 800-832-8238
information@fisher-mfg.com - www.fisher-mfg.com