

APPLICATION:

PRODUCT NAME:  
**STAINLESS STEEL 8" C/C BACKSPLASH SWIVEL STYLE PRERINSE UNIT**

JOB NAME:

SPECIAL CONFIGURATION  
 ■ 24066 CHECK BASE MODEL AND OPTIONS

QUANTITY:

ITEM NO.

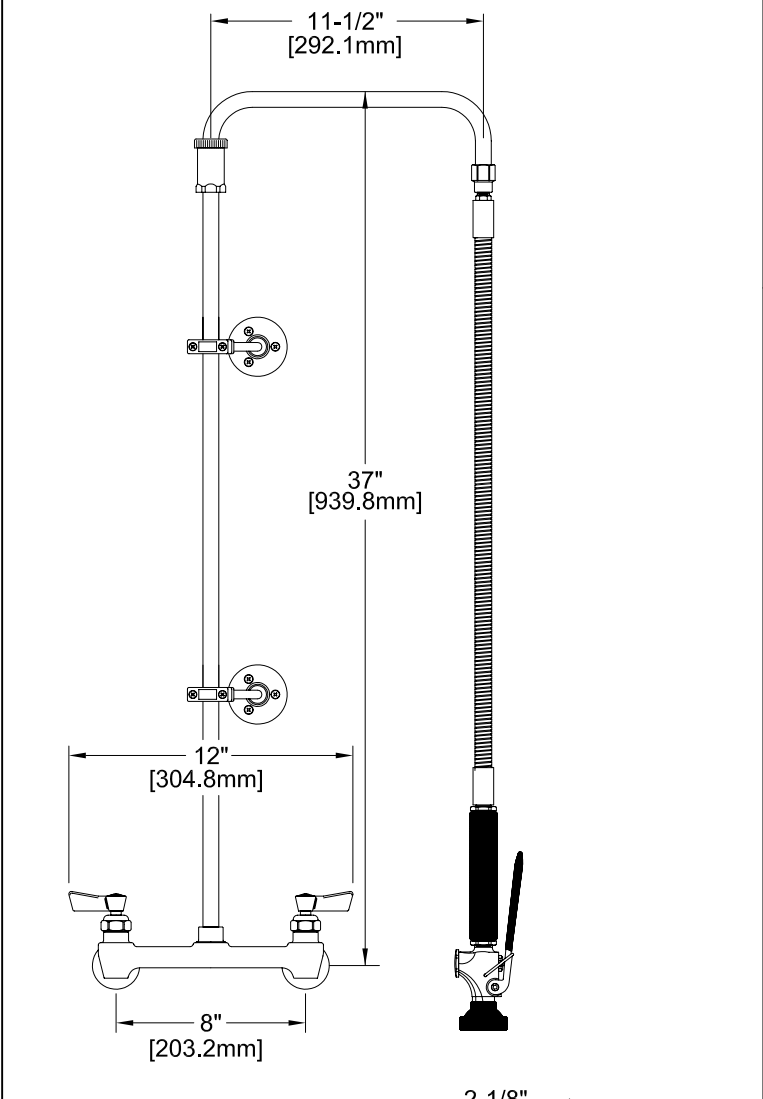

- OPTIONS OR MODIFICATIONS:
- SUPPLY LINES (24" OR 36") CIRCLE LENGTH
  - ADD-ON FAUCET (6", 8", 10", 12", 14", 16") CIRCLE
  - IN-LINE DUAL CHECK VALVE
  - BRUSH
  - ELBOWS
  - VANDAL RESISTANT KIT
  - HANDLES (CROSS OR WRIST) CIRCLE STYLE
  - OTHER 2916-25 1/2" HOSE

- FEATURES:
- CONTROL VALVE**
- \* 8" C/C BACKSPLASH MOUNT
  - \* CONCENTRICS
  - \* INTERNAL SPRING LOADED CHECK VALVES
  - \* SWIVELLING SEAT DISKS
  - \* HOT SIDE STEM - RIGHT HAND
  - \* COLD SIDE STEM - LEFT HAND
  - \* STAINLESS STEEL SEATS
  - \* STAINLESS STEEL SEAT SCREWS
  - \* STAINLESS STEEL HANDLE SCREWS
- HOSE**
- \* 25-1/2" LENGTH
  - \* STAINLESS STEEL END FITTINGS
  - \* STAINLESS STEEL EXTERNAL JACKET
  - \* 3-PLY FIBER REINFORCED INTERNAL RUBBER HOSE
  - \* REPAIRABLE IN FIELD WITH SIMPLE TOOLS
- ULTRA SPRAY VALVE**
- \* LOWEST ENERGY USER - 1.15 GPM @ 60 PSI
  - \* CLEANS FASTER - TEST PROVEN
  - \* ENGINEERED TO LAST - NO 'O' RINGS TO LEAK
  - \* INTERCHANGEABLE - FITS ALL BRANDS
- WALL BRACKET**
- \* ADJUSTS FROM 2" TO 12"

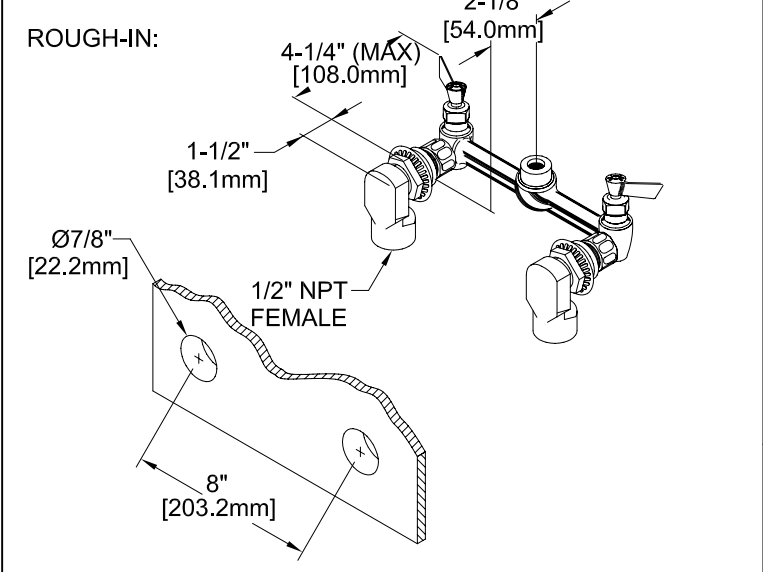

- SYSTEM LIMITS**
- \* TEMP: 40°F MIN. TO 140°F MAX. STATIC
  - \* PRESSURE 200 PSI MAX. STATIC
  - \* SHIPPING WEIGHT: 15.0 LBS
- \* NSF 61-9 APPROVED & LISTED  
[www.truesdail.com](http://www.truesdail.com)

EPAct 2005 Compliant                      ANSI/A112.18.1M

**FISHER**  
 FISHER MANUFACTURING COMPANY  
 TOLL FREE: 800-421-6162 - FAX: 800-832-8238  
[information@fisher-mfg.com](mailto:information@fisher-mfg.com) - [www.fisher-mfg.com](http://www.fisher-mfg.com)