

PRODUCT NAME:  
**STAINLESS STEEL  
 SINGLE DECK BASE**

- 46094 SS DECK BASE WITH 12" SGN
- 45748 SS DECK BASE WITH 6" SGN

FEATURES:

- \* STAINLESS STEEL SINGLE DECK BASE
- \* STAINLESS STEEL SWIVEL GOOSENECK SPOUT
- \* 1/2" SLIP JOINT

SYSTEM LIMITS

- \* TEMP: 40°F MIN. TO 140°F MAX.
- \* PRESSURE 200 PSI MAX. STATIC
- \* 2.20 GPM AT 80 PSI

SHIPPING WEIGHT

- \* 3.0 LBS

\* NSF 61-9 APPROVED & LISTED UNDER MODEL : 59315  
[www.truesdail.com](http://www.truesdail.com)

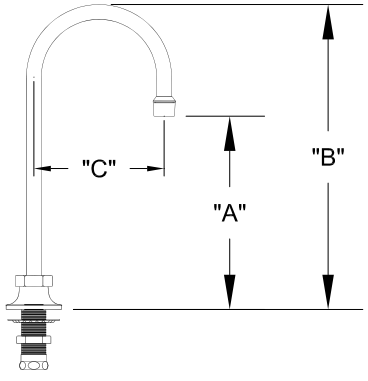

MODEL	DIM "A"	DIM "B"	DIM "C"
46094	8-3/16" [208.0mm]	12-5/16" [312.7mm]	5-1/2" [139.7mm]
45748	4-7/16" [112.7mm]	8-1/16" [204.8mm]	3-1/2" [88.90mm]

ROUGH-IN:

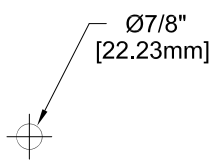

**FISHER**  
 FISHER MANUFACTURING COMPANY  
 TOLL FREE: 800-421-6162 - FAX: 800-832-8238  
[information@fisher-mfg.com](mailto:information@fisher-mfg.com) - [www.fisher-mfg.com](http://www.fisher-mfg.com)