

Pizza/Salad/Sandwich Prep Tables Self-Contained



Models

KS048SC	48" Length	1 Door
KS066SC	66" Length	2 Door
KS072SC	72" Length	2 Door
KS090SC	90" Length	3 Door

Standard Product Features

- » "All-Day" Temperature Performance To NSF7 Test Requirements
- » High Quality Stainless Steel Exterior/ Interior Construction
- » Microprocessor Control
- » 115/60/1V Self-Contained System Using R-404a Refrigerant
- » Stainless Steel Insulated Lift-Up Rail Covers with Two Convenient Open Positions
- » Accommodates Industry Standard Full, Half, Third & 6" Deep Size Pans Without The Use Of Adapter Bars (pans provided by others)
- » Accommodates Sixth & Ninth Size Pans With The Use Of Adapter Bars (pans & bars provided by others)
- » Stainless Steel Field Re-Hingeable Door(s), With Locks
- » Self-Closing Door(s) with Stay Open Feature
- » Metal Door Handle with Gasket Guard
- » Magnetic Snap-In Door Gaskets For Tight Door Seal
- » Gasket-Protecting Stainless Steel Door Liner
- » Two (2) Shelves Per Door, Mounted On Shelf Pins (factory installed)
- » Energy Saving Non-Electric Automatic Condensate Evaporator
- » Hot Gas Evaporator Defrost
- » Thermostatic Expansion Valve Metering Device
- » Large Interior Storage Capacity & Spacious Work Surface
- » 6" Caster On Adjustable Channel Mounting System
- » Side, Front & Rear Access Panel For Ease of Service & Maintenance
- » 9' Cord & Plug Attached
- » One Year Service Labor & 5 Year Compressor Warranty

Options & Accessories

- » Stainless Steel Finished Back
- » Additional Standard Shelves
- » Stainless Steel Shelves In Lieu of Standard Shelves
- » Set of 3-1/2" & 4-5/8" Casters or set of 6" Legs
- » Optional Installed Casters
- » BI-FOLD or LIFT-OFF Rail Covers
- » Full Length White Plastic Cutting Board, 1/2" H x 18" D
- » Full Length Composite Cutting Board, 1/2" H x 18" D
- » Counter Top Garnish Rack
- » 16 Gauge Stainless Steel Single Over shelf (16-1/4" deep)
- » Adapter Bar Package (allows the use of fractional equivalent size pans)
- » Rail Mount Scale Stand
- » Rail Mount Ambient Pan Holder
- » Ticket Rail
- » Two (2) Drawers In Lieu Of One Or More Doors (accommodates 6" deep pans)
- » Three (3) Drawers In Lieu Of One Or More Doors (accommodates 4" deep pans)
- » No. 1 Type Tray Slides To Accommodate either (1) 18" x 26" or (2) 14" x 18" Sheet Pans, Adj. to 2" OC
- » Universal Type Tray Slides To Accommodate either (1) 18" x 26" or (2) 12" x 20" or (2) 14" x 18" Sheet Pans, Adj. to 4" OC
- » Export 220/50/1 Voltage (consult factory)



Equipped With One NEMA 5-15P Plug



Listed by Underwriters Laboratories Inc. and the NSF International in accordance with ANSI/NSF7

Product Specifications

DIMENSIONAL DATA	KS048	KS066	KS072	KS090
Net Capacity cu. ft.	9.5	15.7	17.9	24.4
Number of Pans (third size)	6	9	10	12
Drawer Option ¹ Pan Configurations	Front to Back	Side by Side	See Note 1	Side by Side
Length - Overall in.	48 (121.9 cm)	66 (167.6 cm)	72 (182.9 cm)	90 (228,6 cm)
Depth - Overall in. ²	36 (91.4 cm)	36(91.4 cm)	36(91.4 cm)	36(91.4 cm)
Clear Door Width in.	23	18.7	23 & 18.7	18.7
Clear Door Height in.	20.5	20.5	20.5	20.5
Number of Doors	1	2	2	3
Standard Door Hinging	RH	LH/RH	LH/RH	LH/LH/RH
Number of Shelves	2	4	4	6
Shelf Area sq. ft. ³	9.2	14.8	16.6	22.2
Work Surface Height in.	35-9/16 (90.3 cm)	35-9/16 (90.3 cm)	35-9/16 (90.3 cm)	35-9/16 (90.3 cm)
Height - Overall in.	48-3/8 (122.9 cm)	48-3/8 (122.9 cm)	48-3/8 (122.9 cm)	48-3/8 (122.9 cm)
ELECTRICAL DATA				
Voltage	115/60/1	115/60/1	115/60/1	115/60/1
Full Load Amperes	9.8	9.0	9.0	9.0
NEMA Plug	5-15P	5-15P	5-15P	5-15P
REFRIGERATION DATA				
Refrigerant	R-404a	R-404a	R-404a	R-404a
BTU ⁴	3300	3870	3870	3870
Compressor HP	1/2	1/2	1/2	1/2

CONSTRUCTION, HARDWARE AND INSULATION

Unit exterior top and front sides are constructed of stainless steel, back and bottom is constructed of galvanized steel. Cabinet interior is constructed of stainless steel. Unit is insulated with an average 2" insulation on the top, bottom and all sides.

The 12" wide raised ingredient rail is designed to accommodate standard full, half or third size pans (pans supplied by others). Other size pans require use of adapter bars (pans and bars supplied by others). Accommodates 6" deep pans. Stainless steel insulated lift-up rail cover, with two convenient open positions.

Doors are equipped with self-closing hinges and metal door handle with gasket guard. Each includes an easily removable for cleaning, vinyl magnetic door gasket which assures a tight door seal.

INTERIOR ARRANGEMENTS & SUPPORTS

Unit includes two (2) shelves per door, mounted on shelf pins.

Cabinet is mounted on a set of 6" high heavy-duty casters.

REFRIGERATION SYSTEM

The self-contained refrigeration system cools the cabinet interior, as well as the raised ingredient rail. This system distributes cold air from top to bottom, keeping the pans cold without freezing product and allows for "all-day" temperature performance to NSF7 test requirements. The condensing unit utilizes a hermetically sealed compressor, which is easily accessible behind the louvers. A 9' cord and plug is supplied standard. Standard interior cabinet operating temperature is 34 to 38°F.

WARRANTIES

Both a one year parts and labor warranty and a five year compressor warranty are provided standard.

Notes

Figures in parentheses reflect metric equivalents.

1= KS072 consists of two drawer pan configurations, left hinged door has a side by side pan configuration & right hinged door has a front to back pan configuration (applies to drawer options only)

2= Depth - Overall includes 2" removal stand off bracket located on back of unit. See drawings for detailed dimensions.

3= Area of standard shelf compliment only, does not include storage area of additional shelves or area available on cabinet bottom.

4= Based on a 90 degree F ambient and 10 degree F evaporator.

When ordering please specify: Voltage, Hinging, Options and any additional warranties.

Continued product development may necessitate specification changes without notice.

Pizza/Salad/Sandwich Prep Tables : Self-Contained

Plan & Elevation View- KS048

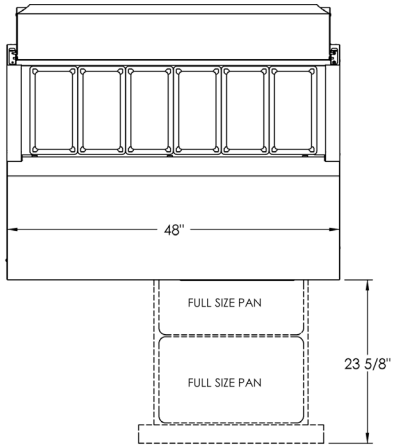

Plan & Elevation View - KS066

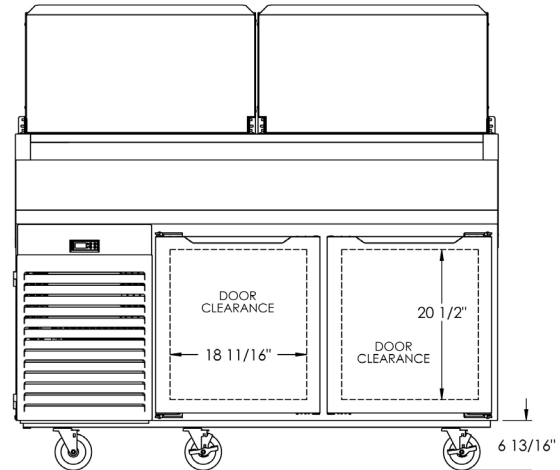
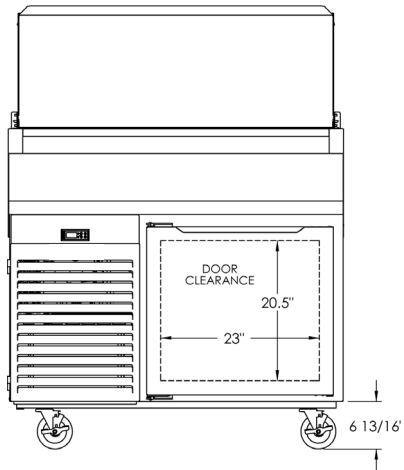
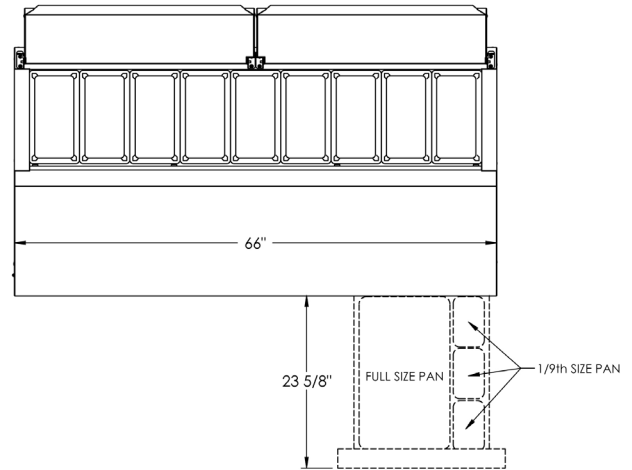

Section View - All Models

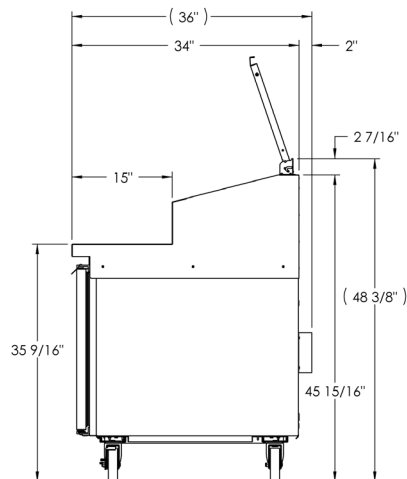

Pizza/Salad/Sandwich Prep Tables : Self-Contained

Pizza/Salad/Sandwich Prep Tables : Self-Contained

Plan & Elevation View - KS072

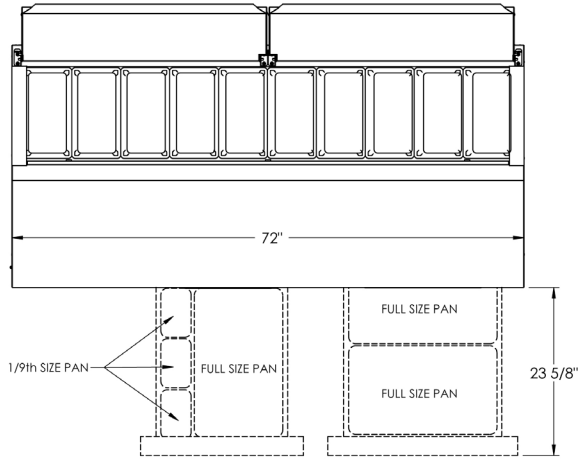

Plan & Elevation View - KS090

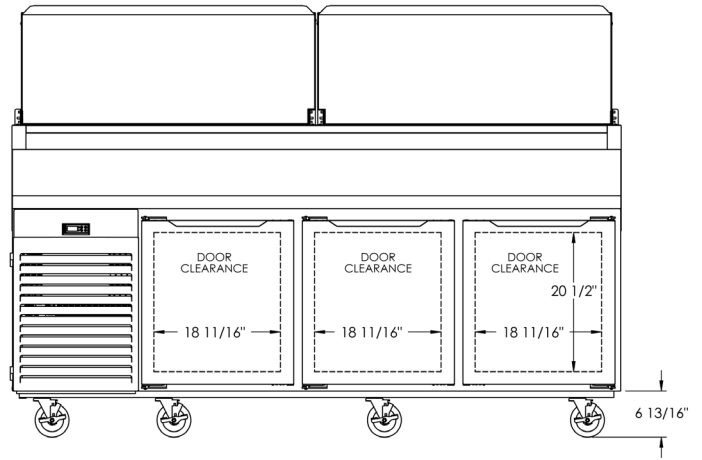
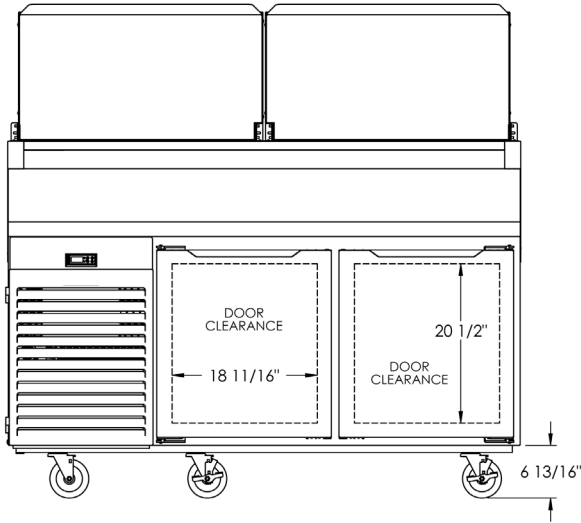
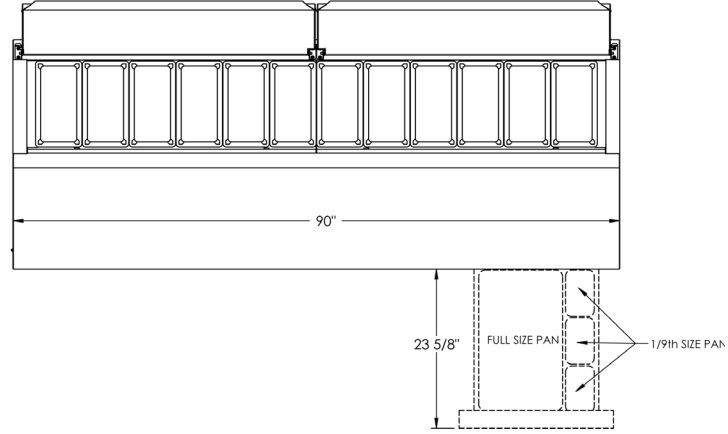

Section View - All Models

