

BANDIT III AIRSCREEN

PROJECT: _____
ITEM: _____ QUANTITY: _____

MODEL # SCRFC-III

SPECIFICATIONS

The Bandit SCRFC III series is a grab and go refrigerator. The self-contained refrigeration system includes digital controls allowing the unit to engage in minimal defrost cycles. Front mounted red indicator light alerts the operator if condensing unit requires cleaning. Unique baffled compressor housing for front air intake, top rear air discharge reducing noise levels plus zero clearance from wall installation. Unit also features an optional roll-down locking night cover.



Available depths: 32 3/8"
Available lengths: 36" 48" 60" 72"
Available heights: 60" 78"

NOTE:
**UNIT SHOWN WITH OPTIONAL STAINLESS
STEEL FINISH AND GLASS END PANELS**

STANDARD FEATURES

- Self-Contained Refrigeration
- Metal Frame Base Construction with Lift-Out Black Louvered Air Grill for Easy Access to Compressor
- Brushed Aluminum Interior Ends
- Standard Grade Laminated Exterior with T-Mold Edge Protection
- Removable Stainless Steel Deck Pan with Hemmed Edge to Contain Spills
- Perforated Stainless Steel Interior Back Panel
- T5 Quick Snap-in Top Canopy Light
- (2) Adjustable Stainless Steel Extra Deep Shelves for Maximum Capacity with T-5 Lighting (60" High Unit)
- (4) Adjustable Stainless Steel Extra Deep Shelves for Maximum Capacity with T-5 Lighting (78" High Unit)
- Electronic Digital Control and Defrost Termination
- Red Indicator Light Alerts Operator if Condensing Unit Requires Cleaning
- Digital Temperature Display
- Unique Internal Baffle Design for Compressor Noise Reduction
- Front Air Intake with Top Rear Air Discharge for Zero Clearance
- Electric Condensate Evaporator Pan
- 8' Cord and Plug
- ETL Listed in Accordance with UL 471 and NSF 7 Standards
- Conforms to NSF STD 7 **TYPE II** Refrigeration
- Environmentally Safe Refrigerant
- 1 Year Parts and Labor Warranty

OPTIONAL FEATURES

- Green Screen
- Stainless Steel Exterior Finish
- Glass End Panels
- Special Laminates
- Miscellaneous Trim
- Wood Veneers (Unfinished)
- Wood Veneers (Stained & Sealed)
- Promolux Lighting (Low UV)
- Wire Shelves:
 - Brass White Black Chrome
- Casters (Increases Height 6")
- Bullet Feet (Increases Height 6")
- Mirrored Polished Stainless Steel Interior Ends
- Mirrored Polished Stainless Steel Perforated Back
- Finished Back with Black Air Grill
- Stainless Steel Louvered Air Grill
- Solid Insulated Rear Sliding Doors
- Removable Locking Security Panels
- Roll Down Locking Night Cover
- Pull Down Econo Night Shade
- #23 Econo Frost Night Shade
- Tie In Strips for Interconnection of Units
- Extra Large Heavy Duty Electric Condensate Evaporator Pan
- Easy Slide-out Condensing Unit
- Remote Refrigeration
- 5 Year Compressor Warranty

WHEN ORDERING, PLEASE SPECIFY:

APPLICATION: _____

REFRIGERATION TYPE: _____

LAMINATE COLOR: _____

BANDIT III AIRSCREEN

TOLL FREE: 800-525-3692

MODEL # SCRFC-III

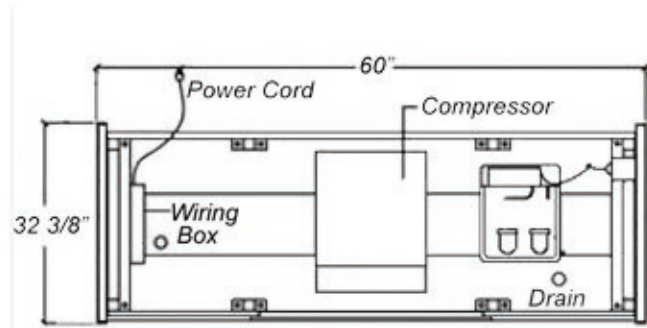
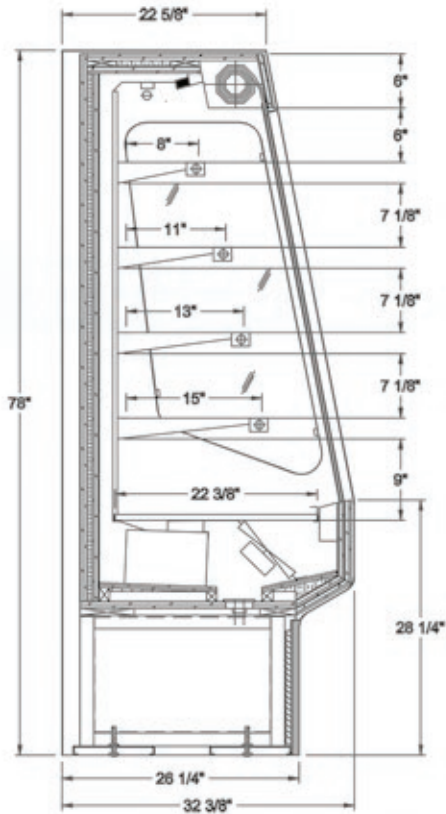

Electrical & Plumbing locations



Conforms to UL Standard 471,
and NSF Standard 7; Certified
To CSA Standard C22.2 No.120

| MODEL | L | D | H | COMP HP | VOLT | AMP | NEMA PLUG | WT | REFRIG |
|------------|-----|---------|-----|---------|--------------------|----------|-----------|-----|--------|
| SCRFC3660R | 36" | 32 3/8" | 60" | 1/2 | (2) 115V | 10.2/8.3 | (2) 5-15P | 575 | 134A |
| SCRFC4860R | 48" | 32 3/8" | 60" | 3/4 | 115/208-230 4 wire | 16.3 | L14-20P | 675 | 404A |
| SCRFC6060R | 60" | 32 3/8" | 60" | 1 1/4 | 115/208-230 4 wire | 16.8 | L14-30P | 775 | 404A |
| SCRFC7260R | 72" | 32 3/8" | 60" | 1 1/4 | 115/208-230 4 wire | 17.4 | L14-30P | 875 | 404A |
| SCRFC3678R | 36" | 32 3/8" | 78" | 1/2 | (2) 115V | 10.2/8.3 | (2) 5-15P | 625 | 134A |
| SCRFC4878R | 48" | 32 3/8" | 78" | 3/4 | 115/208-230 4 wire | 16.6 | L14-20P | 700 | 404A |
| SCRFC6078R | 60" | 32 3/8" | 78" | 1 | 115/208-230 4 wire | 17.3 | L14-30P | 825 | 404A |
| SCRFC7278R | 72" | 32 3/8" | 78" | 1 | 115/208-230 4 wire | 18.0 | L14-30P | 950 | 404A |

1. The 3 ft. unit requires 2 circuits. Total Amps for the 4, 5, 6 ft. units includes 4.8 Amps for the condensate evaporator.
2. Refrigeration System is designed so air will flow front to rear. Unobstructed air flow must be maintained to ensure unit performance and maintain warranty.
3. RPI Merchandiser is designed for use in stores where ambient temperatures and humidity do not exceed 75 Degrees Fahrenheit and 55% R.H. Locate away from direct sunlight, rapid air currents and extreme temperature changes. Exposure to air currents from ceiling fans, air conditioning diffusers, ovens, etc. will disrupt the case air curtain and refrigerated zone. Refrigerated Displays are designed to maintain pre-chilled products. Adding or loading warm products above 41 Degrees Fahrenheit can affect the temperature in the entire cabinet. RPI in line with its policy to continually improve its products reserves the right to change materials and specifications without notice

CALL TOLL FREE: 800-525-3692 (609-714-2330)

FAX: 609-714-2331 www.rpiindustries.com

220 ROUTE 70, MEDFORD, NJ 08055

