

MANHATTAN SERIES

ITEM: _____ QUANTITY: _____

MODEL # SCRFC4848 MS

Shown with optional stainless steel exterior

SPECIFICATIONS

The SCRFC-MS Manhattan Series is a three section display case consisting of a refrigerated self-service lower section, a refrigerated operator serve mid section and a operator serve non-refrigerated upper section. The lower section has a hemmed edge removable deck pan to contain spills. A glass shelf separates the mid and bottom sections for better visibility of product.

Available depths: 35 3/4"

Available heights: 65 1/4"

Available lengths: 48"



STANDARD FEATURES

- Self-Contained Refrigeration
- Stainless Steel Interior Ends
- Standard Grade Laminate Exterior
- Adjustable Stainless Steel Shelf with T5 Light
- Removable Plexiglass Sliding Doors (Upper Section)
- Sliding Rear Doors (Lower Section)
- Removable Stainless Steel Deck Pan with Hemmed Edge to Contain Spills
- Perforated Stainless Steel Interior Back Panel
- T5 Quick Snap-in Top Canopy Light
- Electronic Digital Control and Defrost Termination
- Digital Temperature Display
- Electric Condensate Evaporator Pan
- 8' Cord and Plug
- ETL Listed in Accordance with UL 471 and NSF 7 Standards
- Environmentally Safe Refrigerant
- 1 Year Parts and Labor Warranty

OPTIONAL FEATURES

- Stainless Steel Exterior Finish
- Special Laminates
- Wood Veneers (Unfinished)
- Wood Veneers (Stained & Sealed)
- Promolux Lighting (Low UV)
- Casters
- Bullet Feet
- Powder Coated Interior Back Panel and Hardware
 - Black
 - White
 - Custom Color
- Mirrored Polished Stainless Steel Interior Ends
- Removable Front Security Panels (Lower Section)
- Remote Refrigeration
- 5 Year Compressor Warranty

MANHATTAN SERIES

TOLL FREE: 800-525-3692

MODEL # SCRFC4848 MS

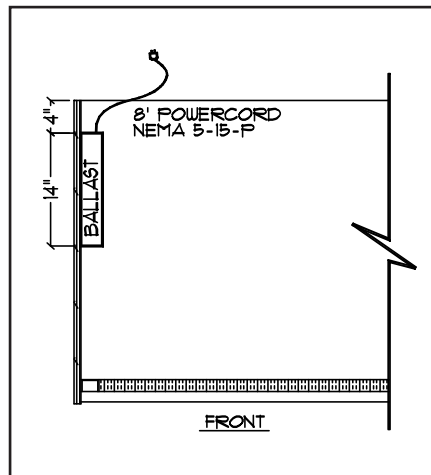
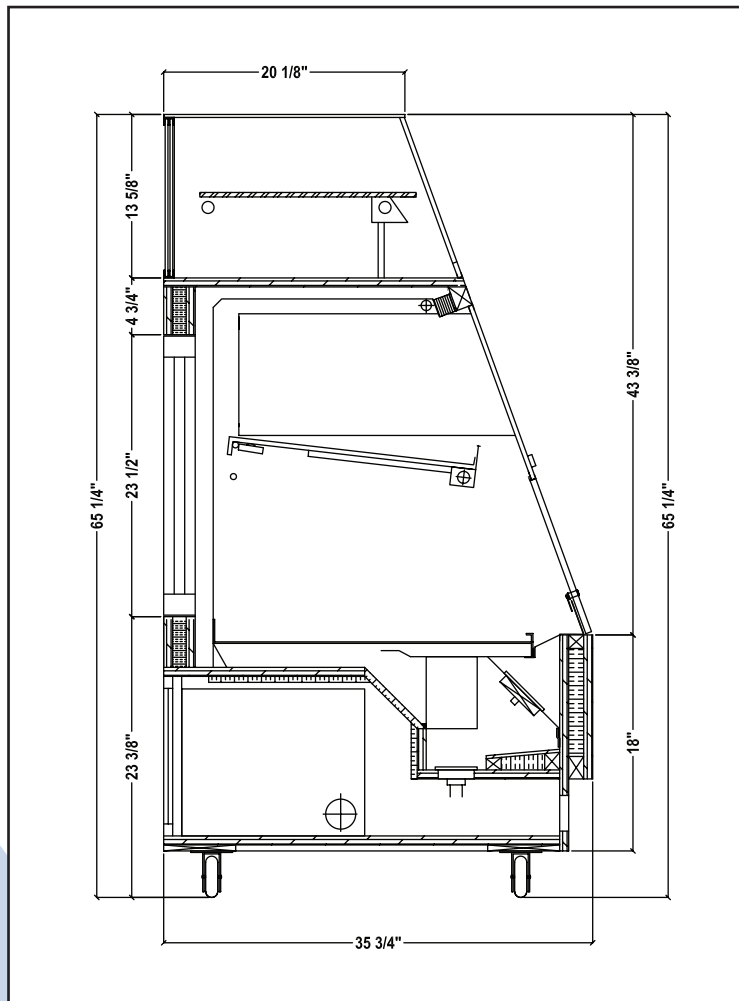

Electrical & Plumbing locations



Conforms to UL Standard 471,
and NSF Standard 7; Certified
To CSA Standard C22.2 No.120

Shown with optional casters

MODEL	L	D	H	COMP HP	VOLT	AMP	NEMA PLUG	WT	REFRIG
SCRFC4848 MS	48	35 3/4	65 1/4	1/2	(2) 115V	13.6/8.3	(1)5-20/(1) 5-15P	360	134A

1. Refrigeration System is designed so air will flow front to rear. Unobstructed air flow must be maintained to ensure unit performance and maintain warranty.
2. RPI Merchandiser is designed for use in stores where ambient temperatures and humidity do not exceed 75 Degrees Fahrenheit and 55% R.H. Locate away from direct sunlight, rapid air currents and extreme temperature changes. Exposure to air currents from ceiling fans, air conditioning diffusers, ovens, etc. will disrupt the case air curtain and refrigerated zone. Refrigerated Displays are designed to maintain pre-chilled products. Adding or loading warm products above 41 Degrees Fahrenheit can affect the temperature in the entire cabinet. RPI in line with its policy to continually improve its products reserves the right to change materials and specifications without notice.

CALL TOLL FREE: 800-525-3692 (609-714-2330)

FAX: 609-714-2331 www.rpiindustries.com

220 ROUTE 70, MEDFORD, NJ 08055

