

# DROP-IN OLYMPUS I

ITEM: \_\_\_\_\_ QUANTITY: \_\_\_\_\_

## MODEL # SCAS-DI-I

SCAS-DI-I - Shown with optional glass vision panels and millwork base.

### SPECIFICATIONS

The SCAS-DI-I is a metal framed base refrigerated self-service display case with a choice of standard grade plastic laminate exterior ends. Designed to drop into a counter.

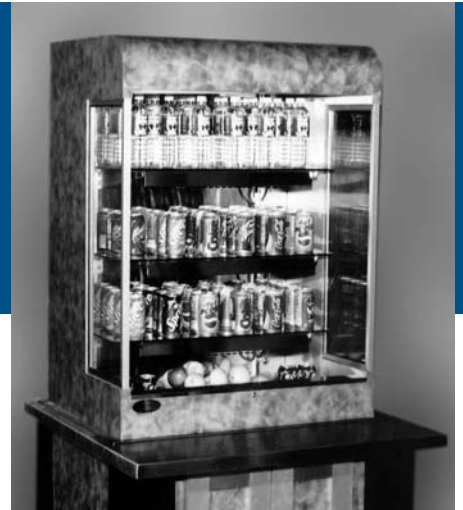

Available depths:  26"

Available lengths:  36"  48"  60"  72"

### STANDARD FEATURES

- Self-Contained Refrigeration
- Metal Framed Compressor Housing
- Rounded Top Canopy
- Brushed Stainless Steel Interior Ends
- Stainless Steel Deck and Perforated Back Panel
- Standard Grade Laminate Exterior
- Top Canopy Light
- 2 Stainless Steel Shelves with Lights
- Stainless Steel Removable Deck Pan - Hemmed to Contain Spills
- Pull Down Energy Saving Night Curtain
- UL Listed in Accordance with NSF 7
- Electric Evaporation Pan
- Separate Circuit for Evaporation Pan for 3' (2) 115V 20 Amp Circuit
- 134A Refrigeration - 3'
- (Neutral Wire Required) 4', 5' and 6'
- R-22 Refrigerant on all but 3' Unit
- Thermometer

### WHEN ORDERING, PLEASE SPECIFY:

APPLICATION: \_\_\_\_\_

\_\_\_\_\_

REFRIGERATION TYPE: \_\_\_\_\_

\_\_\_\_\_

LAMINATE COLOR: \_\_\_\_\_

\_\_\_\_\_

### OPTIONAL FEATURES

- Special Laminates
- Wood Veneers (Unfinished)
- Wood Veneers (Stained & Sealed)
- Miscellaneous Trim
- Promolux Lighting (Low UV)
- Wire Shelves
  - Brass  White  Black  Chrome
- Bullet Feet
- Powder Coated Interior Back Panel and Hardware:
  - Black  White  Custom Color
- Mirrored Polished Stainless Steel Interior Ends
- Finished Back
- Solid Rear Sliding Doors
- See Thru Insulated Rear Sliding Doors
- Econo Frost Night Shade
- Roll Down Locking Security Doors
- Removable Locking Security Panels
- Extra Large Heavy Duty Condensate Evaporation Pan
- Glass Vision Panels
- 5 Year Compressor Warranty

# DROP-IN OLYMPUS I

TOLL FREE: 800-525-3692

## MODEL # SCAS-DI

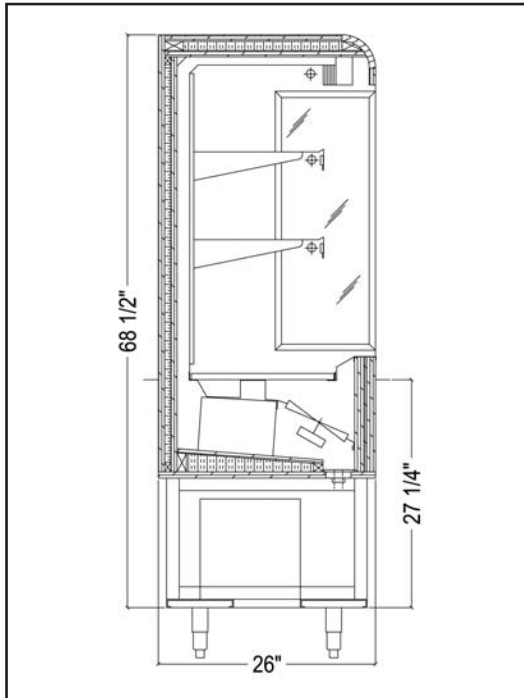

\*34" high cabinets require 6" adjustable stainless steel legs  
 \*36" high cabinets require 8" adjustable stainless steel legs

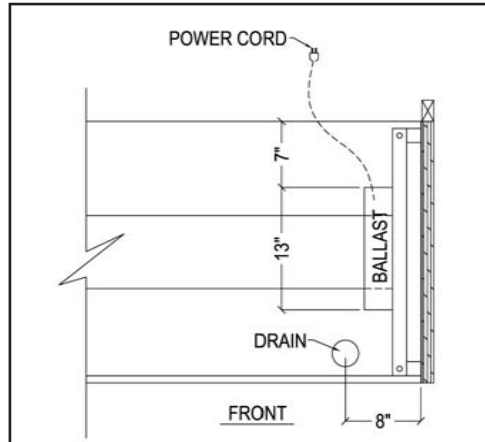

### Electrical & Plumbing locations

Refrigerated Case Display 67C9 Listed  
 Also classified by Underwriters Laboratories Inc.  
 In Accordance with ANSI/NSF 7-1999 and ANSI/NSF 2-1999

**NOTE:** Due to horsepower requirements, noise levels can reach 75 DB"s.  
 Please verify location. Tile floors, low ceilings, small rooms or multiple self-contained units will elevate the noise level. Remote refrigeration is recommended.

| MODEL        | L  | D  | H      | COMP HP | VOLT        | AMP      | NEMA PLUG | WT   |
|--------------|----|----|--------|---------|-------------|----------|-----------|------|
| SCAS36R-DI-I | 36 | 26 | 68 1/2 | 1/2     | (2) 115     | 10.8/8.3 | (2) 5-15P | 700  |
| SCAS48R-DI-I | 48 | 26 | 68 1/2 | 3/4     | 115/208-230 | 13.7     | L14-20P   | 900  |
| SCAS60R-DI-I | 60 | 26 | 68 1/2 | 1       | 115/208-230 | 17.2     | L14-30P   | 1020 |
| SCAS72R-DI-I | 72 | 26 | 68 1/2 | 1       | 115/208-230 | 17.8     | L14-30P   | 1150 |

The 3 ft. unit requires 2 circuits. Total Amps for the 4, 5 & 6 ft. units includes 4.8 Amps for the condensate evaporator.

The SCAS-DI merchandiser is designed for use in stores where temperature and humidity do not exceed 75 degrees F and 55% R. H. Locate away from direct sunlight, rapid air currents and extreme temperature changes. Exposure to air currents from ceiling fans, air conditioners, ovens, etc. will disrupt the case's air curtain and refrigerated zone within. Any adverse conditions will affect warranty. RPI in line with it's policy to continually improve it's product reserves the right to change materials and specifications without notice.

**NOTE:** Verify that the in-field installation has sufficient height access to lift units into counter openings without upper soffit obstructions.

CALL TOLL FREE: 800-525-3692 (609-714-2330)

FAX: 609-714-2331 www.regalpinnacl.com

220 ROUTE 70, MEDFORD, NJ 08055

**RPI** REGAL PINNACLE INTEGRATIONS INDUSTRIES, INC.