

VIENNA COLD DISPLAY

PROJECT: _____

ITEM: _____ QUANTITY: _____

MODEL # VICD-SQ SQUARE GLASS

Shown with optional counter.

SPECIFICATIONS

The VICD-SQ Vienna Series drop-in is a refrigerated full service display merchandiser, featuring square front glass and side panels. Unit is available in choice of three heights with rear see through doors. Modified for 1/2 refrigerated display and 1/2 non-refrigerated display.



Available depths: 27 3/8"

Available (above counter) heights: 20 7/8" 27 5/8" 34 1/4"

Available lengths: 31 1/2" 44 1/4" 57 1/8" 69 7/8"

STANDARD FEATURES

- Solid Front Tempered Glass
- 304 Stainless Interior
- Programmable Refrigeration Controller
- Fully Automatic Hot Gas Defrost
- Forced Air Cooling System
- Self-Contained Refrigeration System with Pull Out Compressor Housing
- Lift Up Evaporator
- Removable Air flow Pans for Cleaning
- Hinged Rear See Through Access Doors
- Easily Removable Side Glass Panels
- Tilt Out Front Glass
- Environmentally Safe Refrigerant

OPTIONAL FEATURES

- Remote Refrigeration (Hot Gas Defrost Not Available)
- Flip Up Compartment Doors
- 5 Year Compressor Warranty
- Rear Air Ventilation Kit
- Integration Modular Counters (Consult Factory)



WHEN ORDERING SPECIFY:

Application: _____

Refrigeration Type: _____

MODEL	L	W	H ABOVE COUNTER	COMP HP	VOLT	AMPS	NEMA PLUG	WT	CUT-OUT SIZE
VICD2-20-R-SQ-SC	31 1/2	27 3/8	20 7/8	1/4	115	4.7	5-15P	339	29 7/8 x 26 3/8
VICD3-20-R-SQ-SC	44 1/4	27 3/8	20 7/8	1/4	115	5.0	5-15P	403	42 3/4 x 26 3/8
VICD4-20-R-SQ-SC	57 1/8	27 3/8	20 7/8	1/3	115	6.3	5-15P	470	55 1/2 x 26 3/8
VICD5-20-R-SQ-SC	69 7/8	27 3/8	20 7/8	3/8	115	7.9	5-15P	537	68 1/4 x 26 3/8
VICD2-27-R-SQ-SC	31 1/2	27 3/8	27 5/8	1/4	115	5.0	5-15P	356	29 7/8 x 26 3/8
VICD3-27-R-SQ-SC	44 1/4	27 3/8	27 5/8	1/3	115	6.1	5-15P	426	42 3/4 x 26 3/8
VICD4-27-R-SQ-SC	57 1/8	27 3/8	27 5/8	3/8	115	7.9	5-15P	500	55 1/2 x 26 3/8
VICD5-27-R-SQ-SC	69 7/8	27 3/8	27 5/8	1/2	115	8.9	5-15P	573	68 1/4 x 26 3/8
VICD2-34-R-SQ-SC	31 1/2	27 3/8	34 1/4	1/3	115	6.0	5-15P	373	29 7/8 x 26 3/8
VICD3-34-R-SQ-SC	44 1/4	27 3/8	34 1/4	3/8	115	7.7	5-15P	449	42 3/4 x 26 3/8
VICD4-34-R-SQ-SC	57 1/8	27 3/8	34 1/4	1/2	115	8.9	5-15P	530	55 1/2 x 26 3/8
VICD5-34-R-SQ-SC	69 7/8	27 3/8	34 1/4	1/2	115/230	7.4	14-20P	609	68 1/4 x 26 3/8

VIENNA COLD DISPLAY

MODEL # VICD-SQ SQUARE GLASS

VICD-20-R-SQ-SC

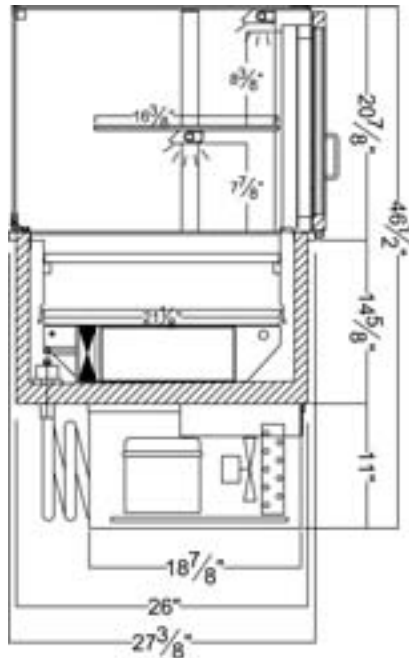

VICD-27-R-SQ-SC

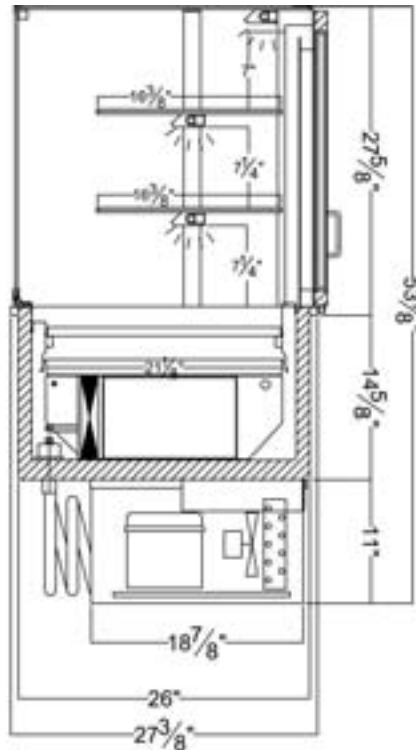

VICD-34-R-SQ-SC

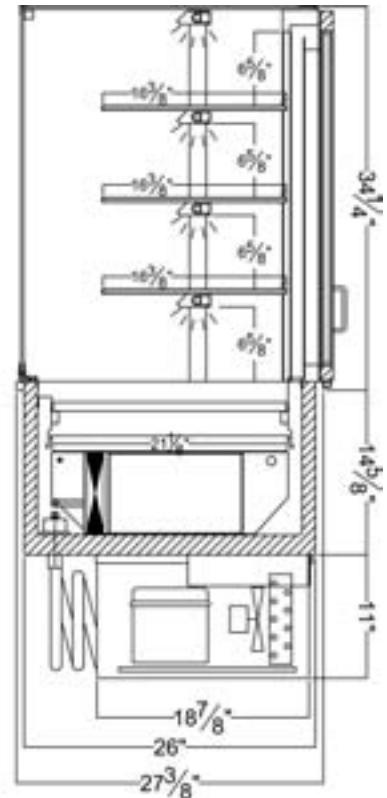

LARGEST DIMENSION REPRESENTS OUTSIDE FLANGE

- 1.** A 1" diameter drain is provided. The drain **MUST** be connected to a floor drain or storage container **AT TIME OF INSTALLATION**.
- 2.** Front and Rear ventilation louvers, each at least 25" W x 20" H, **MUST** be provided in the cabinet or counter and located so to provide full ventilation for the condensing unit.
- 3.** The VICD-SQ merchandiser is designed for use in locations where temperatures and humidity do not exceed 75 degrees and 55% R.H. Any adverse conditions will affect warranty. Locate away from direct sunlight, rapid air currents and extreme temperature changes. Exposure to air currents from ceiling fans, air conditioners, ovens, etc. will disrupt the cases air current and refrigeration zone within.

RPI in line with it's policy to continually improve it's product reserves the right to change materials and specifications without notice.



LARGEST DIMENSION REPRESENTS OUTSIDE FLANGE

VIENNA COLD DISPLAY

TOLL FREE: 800-525-3692

MODEL # VICD-SQ SQUARE GLASS

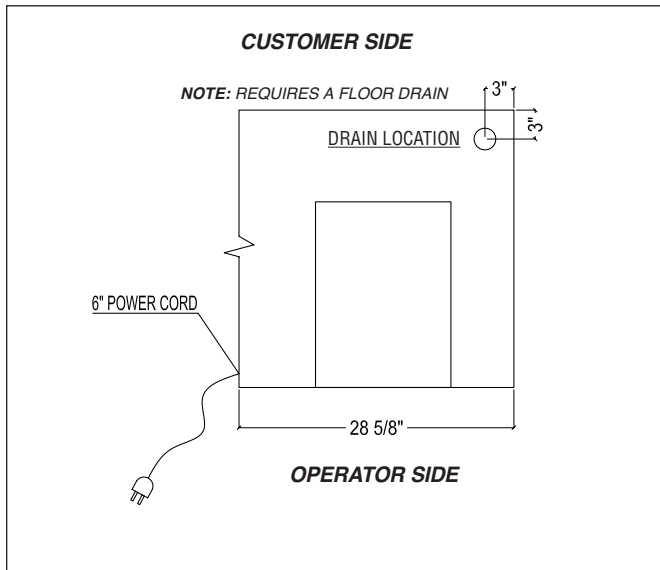

Electrical & Plumbing locations



CALL TOLL FREE: 800-525-3692 (609-714-2330)

FAX: 609-714-2331 www.regalpinnacle.com

220 ROUTE 70, MEDFORD, NJ 08055

RPI REGAL
PINNACLE
INTEGRATIONS INDUSTRIES, INC.